

LEGEND

- The Order Limits
- Main Site
- Indicative Area:
 - Abstraction Option
 - Additional Abnormal Indivisible Load Route
 - Additional Area for Landscaping and Biodiversity Provision
 - New Permanent Access from A18
 - Electrical Connection Area to National Grid 400kV Substation
 - Emergency Vehicle Access Road
 - Gas Above Ground Installation (AGI)
 - K2 / K3 Turnaround Area / CCR Area
 - K2 Operational / Laydown
 - Keadby 1
 - Keadby 2
 - Keadby 3 Construction Laydown Areas
 - Potential Electrical Connection to Northern Powergrid 132kV Substation
 - Proposed PCC Site
 - Water Connection Corridor
 - Water Discharge Corridor
 - Waterborne Transport Off-Loading Area
 - Existing Gas Connection

NOTES
Reproduced from Ordnance Survey digital map data © Crown copyright 2021. All rights reserved. Licence number 0100031673. © National Grid UK

ISSUE PURPOSE
ENVIRONMENTAL STATEMENT
PROJECT NUMBER
60625943
SHEET TITLE
Indicative Work Areas Referred to in the Environmental Statement
SHEET NUMBER
Figure 3.3

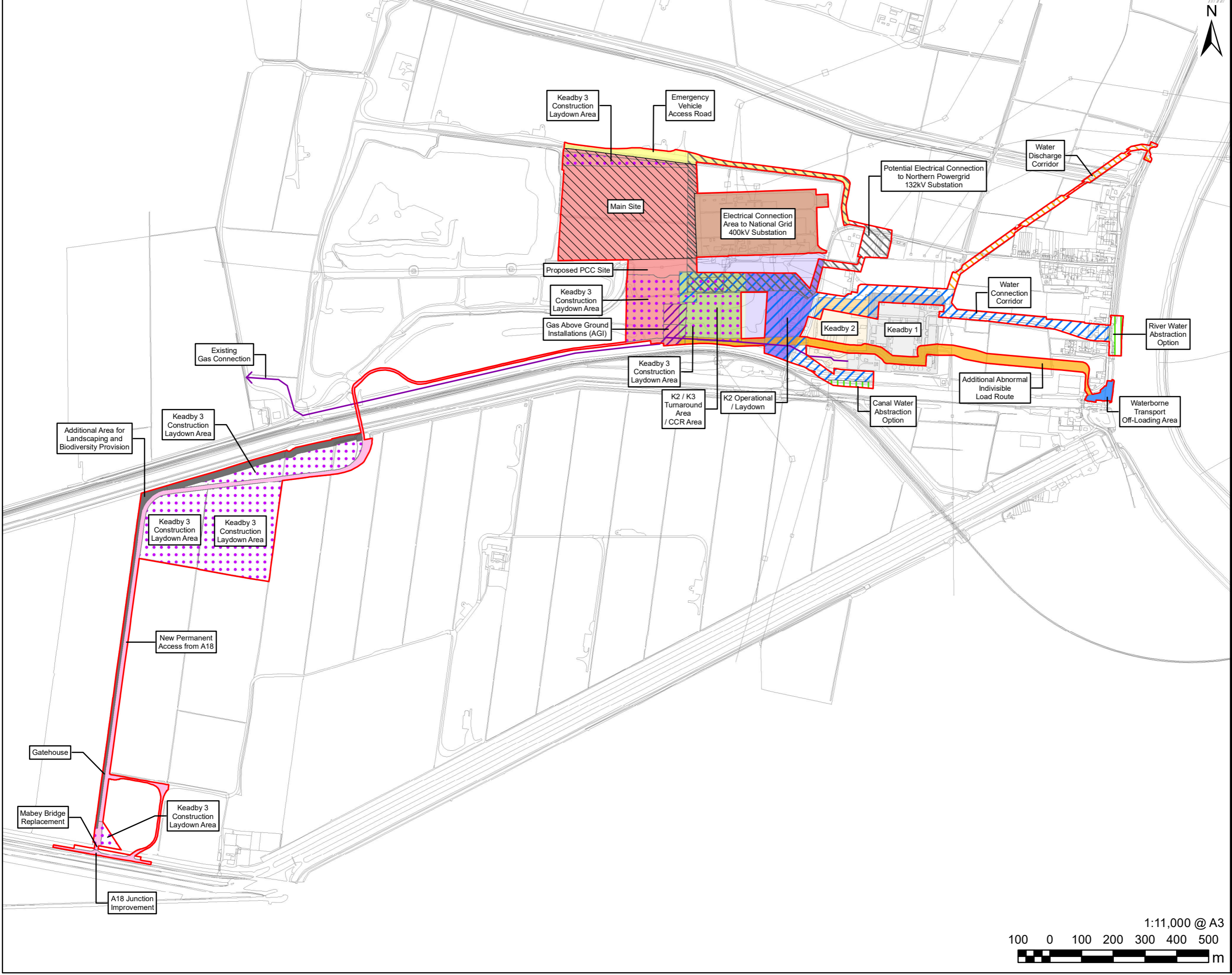

Revision: 01 Drawn: JW Checked: CN Approved: RW Date: 13/05/2021
Filename: K:\07 CAD & GIS\02_Maps\Environmental Statement\K_ES_Fig3_3_Indicative_Work_Areas_A3_20210506_R01.mxd